

Giant Wind Flag Installation Guide

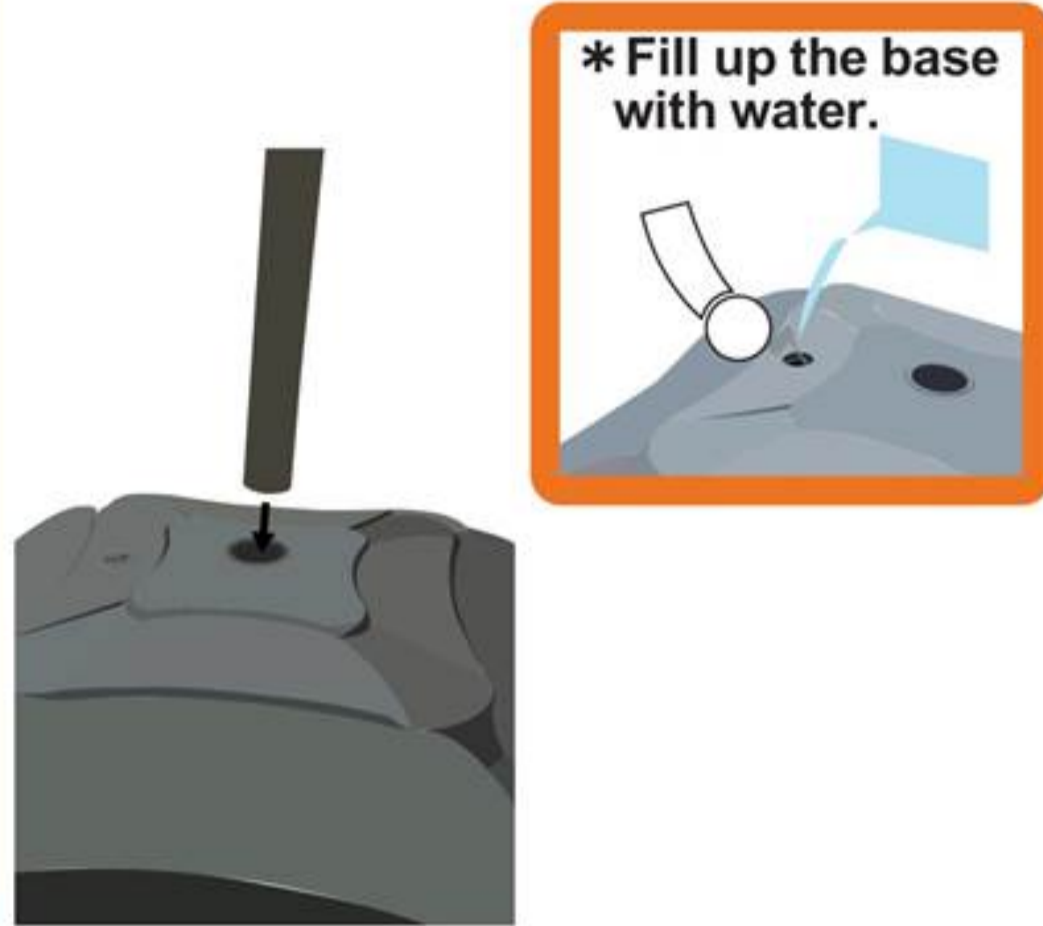

Step 1.
Place the pole in the middle of the base.



Step 2.
Place the support feet and 10 big rings into the pole.



Step 3.
Place the support feet in the openings at the corners of the base.

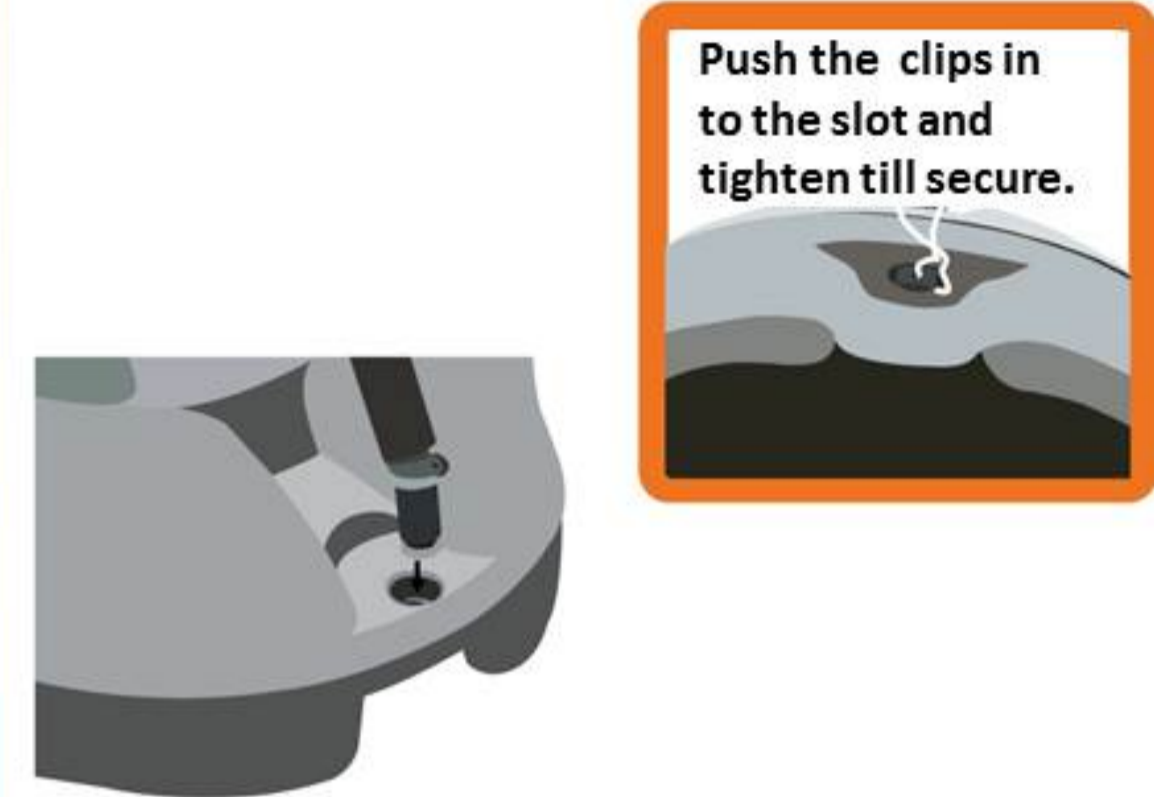

Step 4.
Open the top screw, place the hanger on top of the pole & fix the hanger with the screw.

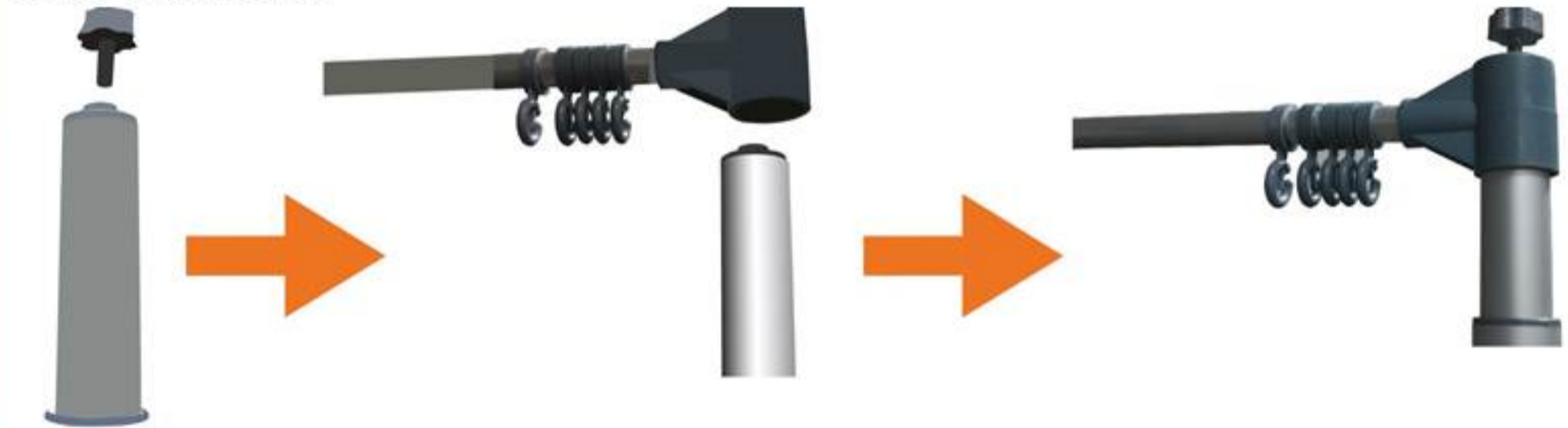

Step 6.
Pull the pole up and hang the flag using the big rings.

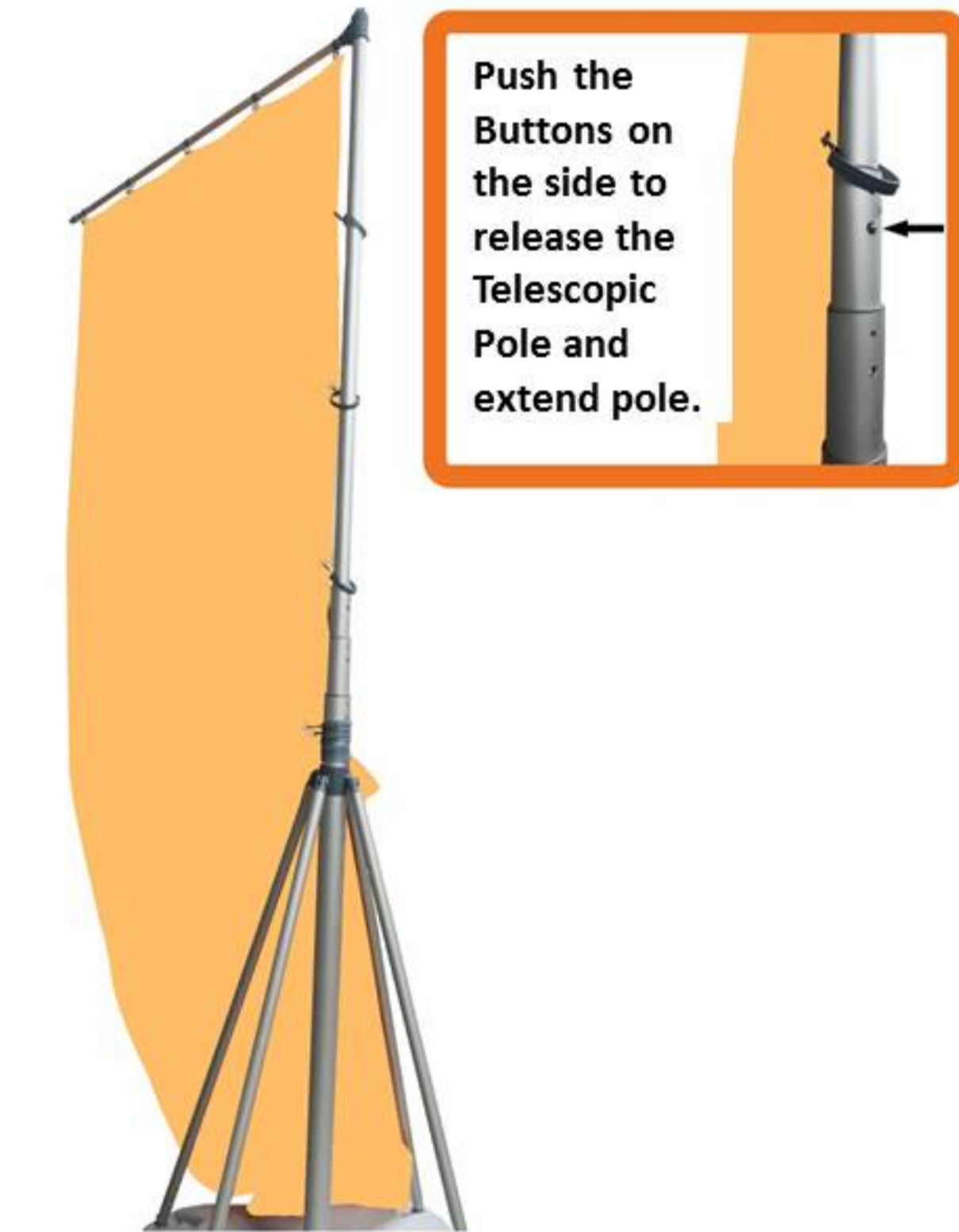

Step 5.
Hang the flag using the small rings on the hanger

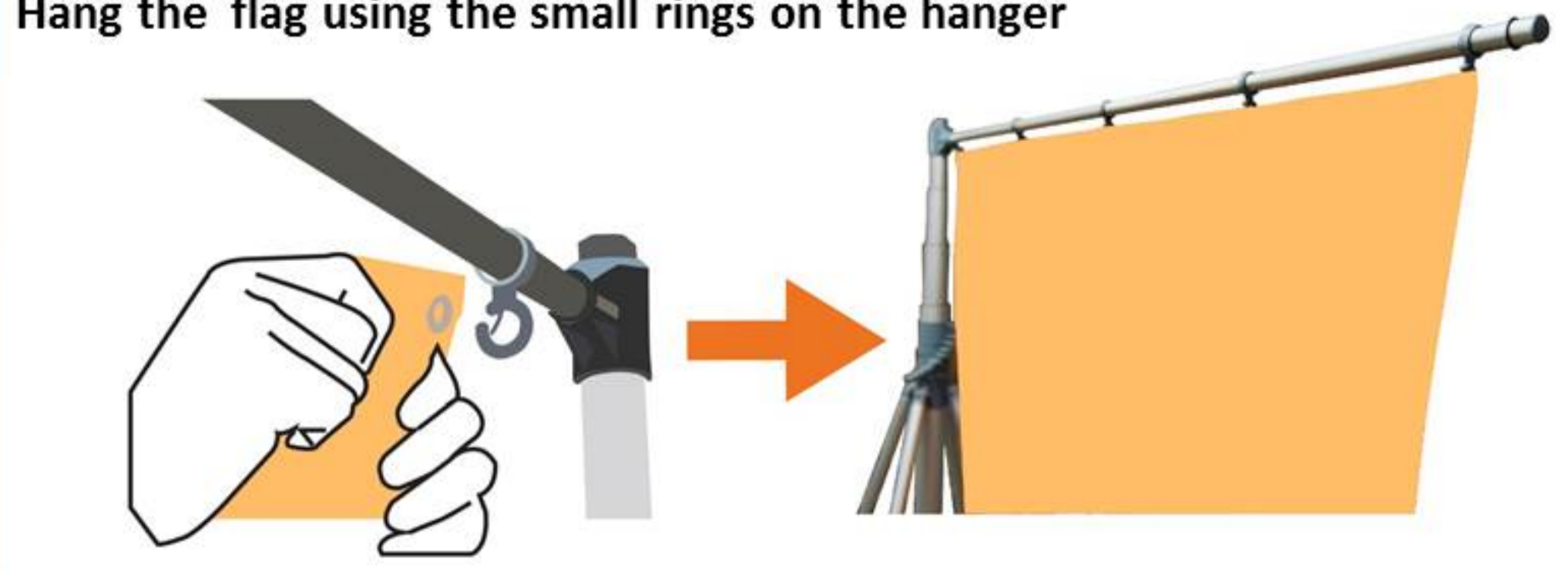

Step 7.
Installation complete.

